

4840, solder terminal, Socket, 6.3 mm, 2-pole, DC Plug/Socket



Description

- Solder terminal :
Screw-on mounting , from rear-side
- Low Voltage DC Plug and Socket
- DC Plug: 2-pole , straight

Technical Data

Diameter	6.3 mm / 2.35 mm	Allowable Operation Temperature	-20 °C to 70 °C
Number of Poles	2-pole	Terminal	solder terminal silver plated
Ratings DC	1 A / 12VDC	Mounting	Screw-on mounting wall thickness max. 5.5mm
Dielectric Strength	500VDC	Style	straight
Insulation Resistance	> 100 MΩ @ 500VDC	Lifetime	5000 Insertions

Detailed information on product approvals, code requirements, usage instructions and detailed test conditions can be looked up in [General Product Information](#)

Dimensions

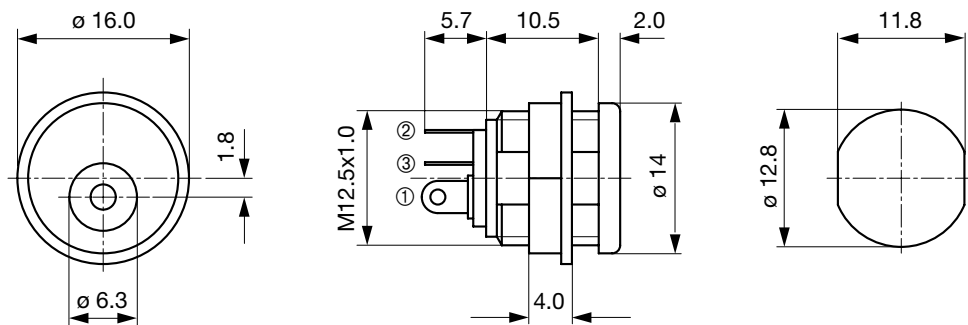

Diagrams

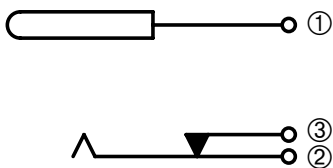

All Variants

Product group	Diameter [mm]	Number of Poles	Terminal	Order Number
DC Plug/Socket	6.3	2-pole	solder terminal	4840.2210

Most Popular.

Availability for all products can be searched real-time: <http://www.schurter.com/en/Stock-Check/Stock-Check-SCHURTER>

Packaging unit 250 Pcs

Mating Inlets/Plugs

Category / Description

[DC Plug/Socket Overview complete](#)



4840, solder terminal, Plug, 5.5 mm, 2-pole, DC Plug/Socket	4840.1210
4840, Cable, Plug, 5.5 mm, 2-pole, DC Plug/Socket	4840.5210
4840, Cable, Plug, 5.5 mm, 2-pole, DC Plug/Socket	4840.5211

[DC Plug/Socket further types to 4840.2210](#)